

VILLAGE OF NEW LENOX
MISCELLANEOUS PERMIT FORM

PERMIT NO. _____

APPLICANT INFORMATION

APPLICANT / OWNER: _____

ADDRESS _____
(address of where work will be performed)

CONTACT PHONE NUMBER: _____

REAL ESTATE PROPERTY TAX ID # _____

DESCRIPTION OF WORK: _____

WORK TO BE COMPLETED BY:

PROPERTY OWNER: _____ OR

CONTRACTOR: _____

Village of New Lenox Contractor Registration Number _____

I HEREBY CERTIFY THAT I HAVE READ, UNDERSTAND AND AGREE TO CONFORM TO ALL GOVERNING INFORMATION AND REGULATIONS SET FORTH BY THE VILLAGE BOARD OF NEW LENOX.

SIGNATURE: _____

MISCELLANEOUS PERMIT CHECK LIST

THE FOLLOWING INFORMATION MUST BE SUBMITTED ALONG WITH THE PERMIT APPLICATION

SEE THE MISCELLANEOUS BUILDING GUIDE FOR COMPLETE
DETAILED INFORMATION AND ORDINANCE REQUIREMENTS

ABOVE GROUND SWIMMING POOLS / HOT TUBS

1. Submit a site plan (plat of survey) and show where the pool will be placed
2. Indicate the dimensions of the pool
3. Indicate side yard setback (10 ft minimum), rear yard setback (10 ft minimum), and distance from pool to house (5 ft minimum)
4. Indicate location and height of fence (either proposed fence or existing fence)
5. Hot tubs require fencing or locking hard cover (please indicate on site plan)
6. \$100 cash deposit is required for all pool/hot tub permits. Please submit completed Swimming Pool Deposit form with permit application.

SHEDS / ACCESSORY BUILDINGS

1. Submit a site plan (plat of survey) that indicates where shed will be placed
2. Indicate dimensions of shed (180 sq ft maximum) and height of shed (15 ft maximum)
3. Indicate side yard setback and rear yard setback (5 ft minimum)
4. Indicate distance from shed to house (10 ft minimum)

DECKS / GAZEBO / PORCH

1. Submit a site plan (plat of survey) and show where deck will be placed
2. Indicate dimensions of deck
3. Submit construction details (see miscellaneous building guide for deck requirements)

FENCES

1. Submit a site plan (plat of survey) showing location of fence and height of fence (the contractor's proposal will not be accepted as a site plan)
2. Indicate that supporting posts will be exposed to the interior of the lot and not facing the adjoining properties

DRIVEWAYS

1. Submit a site plan (plat of survey) showing location of driveway for new or replacement driveways
2. Indicate material to be used for driveway (asphalt or concrete)
3. If using concrete, submit concrete specifications (see Miscellaneous Building Guide for concrete specifications)

VILLAGE OF NEW LENOX
1 VETERANS PARKWAY, NEW LENOX, IL 60451

PERMIT # _____

SWIMMING POOL DEPOSIT

DEPOSITOR'S NAME: _____

ADDRESS OF POOL
INSTALLATION: _____

MAILING ADDRESS _____
(FOR REFUND)

(City) (State) (Zip)

TELEPHONE: _____

EXPIRATION DATE: _____

TYPE OF INSTALLATION

INGROUND POOL/HOT TUB _____
ABOVE GROUND POOL / ATTACHED FENCE _____
ABOVE GROUND POOL / FENCED YARD _____

I have deposited with the Village of New Lenox, the sum of \$100.00

_____ CASH
_____ CASHIER CHECK
_____ BANK MONEY ORDER

NOTIFY THE BUILDING DEPT. WHEN POOL IS COMPLETED TO SCHEDULE AN
INSPECTION.

I understand that this deposit will be returned to me on the next available disbursement
after approval of the project.

SIGNATURE

Date: _____

VILLAGE OF NEW LENOX

Date: _____

DATE RELEASED: _____

(COPIES OF FORMS & CHECK)
FINANCE _____
CONTRACTOR _____
BLDG FILE _____
BOND BOOK _____

VILLAGE OF NEW LENOX
ABOVE GROUND POOL PERMIT REGULATIONS

INFORMATION TO BE SUBMITTED WHEN APPLYING:

Completed Building Permit Application

Plat of Survey – include the following details on survey: (see sample surveys)

- Pool Location – distances to property lines
- 30 ft. front yard, corner lots have two front yards
- 10 ft. side and rear
- 5 ft. from house for above ground pools
- 10 ft. from house for in-ground pools

POOLS ARE NOT PERMITTED WITHIN THE FRONT YARD SETBACK.

Fencing – 6 ft. minimum from grade

- Gates must be self closing, self latching
- Maximum 4-inch spindle spacing between any fence opening into pool area.
- Fence can be installed around the perimeter of pool with a fence height of 6 ft from grade at lowest point.
- Fence can be installed around the yard enclosing pool area. (This requires separate fence permit)
- Permanent fencing must be installed within 30 days of permit approval
- All supporting posts shall be exposed to the lot interior and shall not face the adjoining properties.

Electric Requirements

- Indicate existing underground or overhead lines
- Pools cannot be located within 10 ft. of overhead lines
- Indicate locations of proposed or existing receptacles. All receptacles require GFI protection with IN USE covers.
- Indicate material and burial depth of conductors
- Indicate location of pumps and filters
- Method of grounding

Miscellaneous:

Construction details:

Must be installed in compliance with the International Building Code.
Submit construction details for pool deck, stairs, guardrails, etc.

Contractors:

All contractors working on the project must be registered prior to approval of the project.

Inspections:

Contact the Village Office when work is completed.

JU.L.I.E.

Contact JULIE 800-892-0123 for utility locates prior to any digging.

DEPOSIT:

A \$100.00 cash deposit (cash, money order or cashiers check) will be required at time of permit approval or at time of verbal request. This deposit will be returned at the next available disbursement after approval of project by the Building Department.

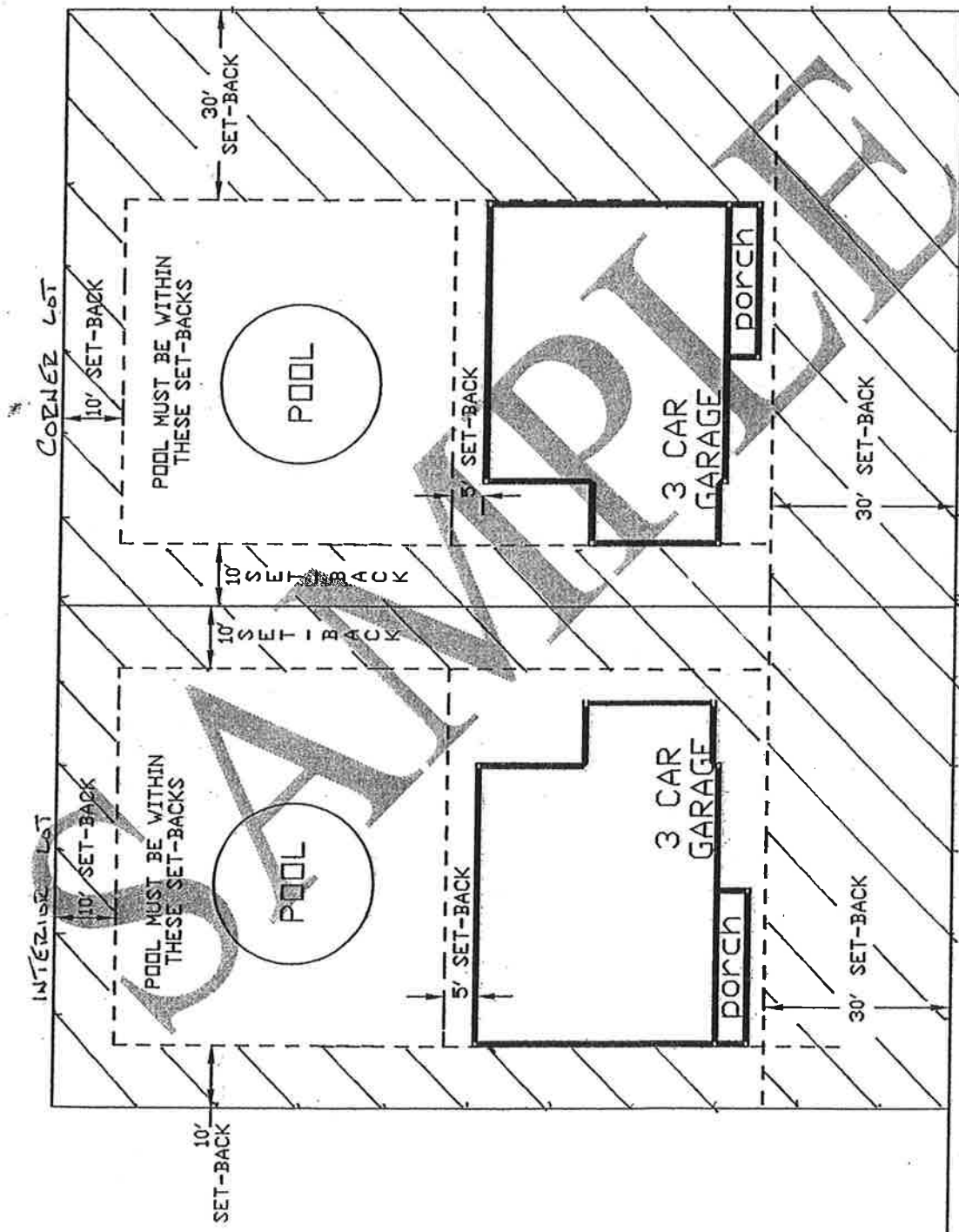

'A STREET'